

# Technical Specification

## S-DLP/1S/43/FL - Flood

### Complete DALI Self Test

### 700mA Stand-Alone Recessed Em LED

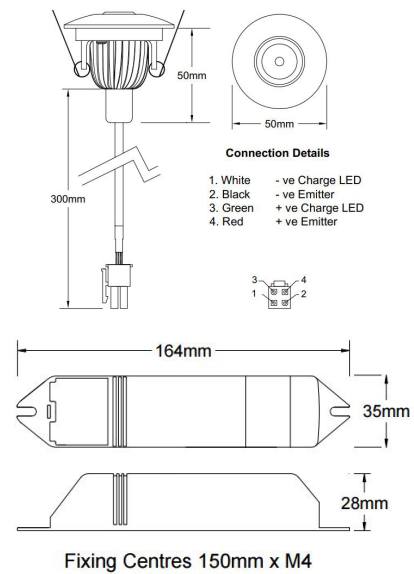
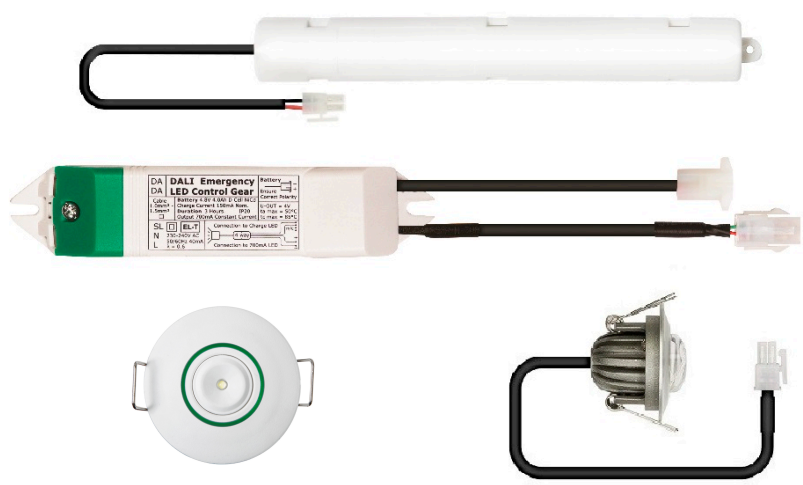

- Suitable for Ceiling Recess Applications.
- Deep Discharge Protection
- Plugs and Leads for Simple Installation
- Ferruled Cables for Mains Input
- Strain Relief Module
- Features LiFePO4 Extra Long Life Batteries
- 43mm Ceiling Cut-Out
- No Lens - Flood
- 115° Beam Angle
- Features Halo Effect Bi-Colour Charge LED
- DALI 1 Device registered with DiiA

The S-DLP/1 DALI Self Test range is supplied with LED/43/FL designed for ceiling recess applications. The non-maintained emergency driver is supplied with strain relief cables and passes through a 43mm aperture.

A 3 hour emergency lighting driver that operates at 700mA in emergency only. This range operates with lithium iron phosphate (LiFePO4) batteries which not only consume far less power under operation, but last far longer than traditional emergency lighting batteries.

#### Weblinks:

- [Eulumdat File - LED/43/FL @ 700mA](#)
- [LED/43/FL Conformity](#)
- [Installation Instructions .pdf](#)

There are 1 main versions available -

#### Order Codes

S-DLP/1S/43/FL/W	Complete 237 Lumen Emergency Solution with 115° Beam Angle LED - IP20 White Bezel RAL 9016
------------------	--

#### Technical Details:

Mains Supply	230-240V AC 50/60 Hz	Max Ta and Tc	Ta = 40 °C & Tc = 70 °C
Power Rating (Standby)	8mA λ = 0.14	Max Battery Temperature	60 °C
Power Rating (Charging)	16mA λ = 0.46	Battery Discharge Current	950mA
Recharge Period	24-Hours	Discharge Voltage Cut Off	2.5Volts
Battery Size & Type	3.2V 4.5Ah LiFePO4	Ingress Protection	Control Gear IP20 (Head IP20)
Charge Current	Dual Rate 0-250mA	Mains Input	1.0mm <sup>2</sup> - 1.5mm <sup>2</sup>
Protection Class	II	Module Dimensions (LxWxH)	164mm x 35mm x 28mm
Overall Weight (with LED)	0.61Kg	Battery Dimensions (LxØ)	220mm x 32mm

